

The information contained herein represents that information contained in official records. Any conclusions drawn from such information will be drawn at the sole risk of the user. The use of the data contained herein, and any products derived therefrom, for the purpose of solicitation to by or sell any product, property or service is strictly prohibited.

Township 23S Range 02E

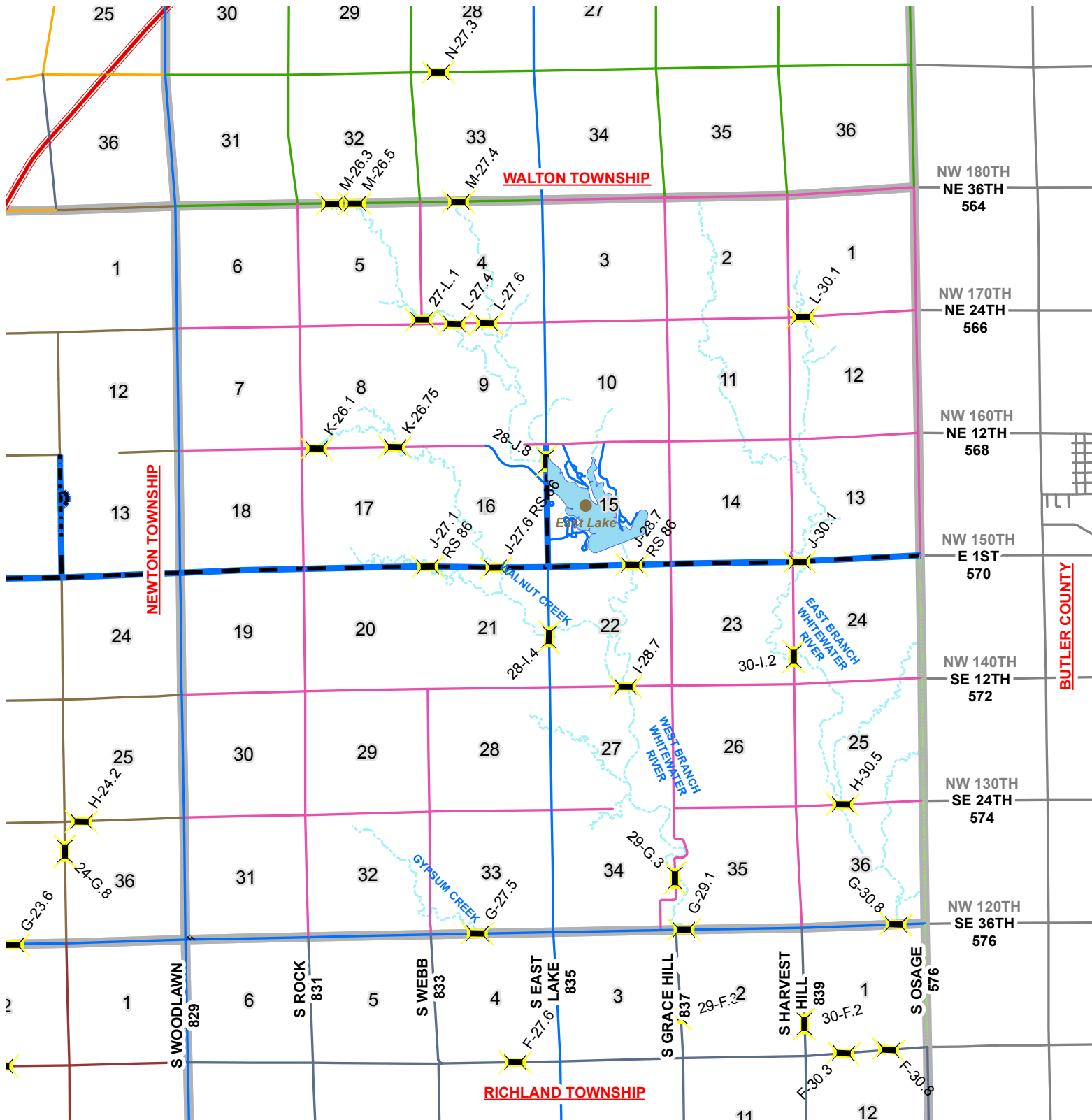

**Legend**

- Landmark
- Lakes
- Railroads
- Bridge # N-27.3
- Harvey County - Paved
- Harvey County - Unpaved
- Richland Township
- Butler County
- Newton Township
- Township Boundaries
- Pleasant Township
- Walton Township
- Surrounding County Roads
- Creeks/Rivers
- 5 Section Number